



HUTT CITY
COUNCIL

30 Laings Road
Private Bag 31912, Lower Hutt
New Zealand
<http://www.huttcity.govt.nz>

Contact: Kelly Crandle
Group/Division: Leisure Services
Telephone: 04-570-6774
Facsimile: 04-569-1625
E-Mail: Kelly.Crandle@huttcity.govt.nz
Our Reference: PL13 - 3 - 1

30 May 2000

Susan Edwards
Wellington Regional Council
PO Box 11646
WELLINGTON

Dear Susan

MCKAY/SHAW PROPERTY - YORK BAY

Recently Council considered the possibility of swapping land in Sorrento Bay with land in York Bay owned by Andrew McKay and Vicky Shaw. The issue became quite complicated and eventually Council decided against the proposal to swap land. Instead, they requested that officers investigate the possibility of acquiring the property using Council's Reserve Purchase and Development Fund and by seeking financial assistance from the Wellington Regional Council and the QEII National Trust.

The McKay/Shaw property stretches between York Bay and Lowry Bay. The street address is 2 Waitohu Road, York Bay. It contains sections of the Francis Bell Track and the Main Ridge Track. These are important recreational tracks in the Eastern Bays of our city.

I am writing to request that the Regional Council consider this Council's request to contribute towards the acquisition of approximately 8 hectares of the 24 hectare McKay/Shaw property for the purpose of gaining permanent public access to the tracks. A registered valuer has assessed the McKay/Shaw property. It is estimated that the property is worth \$3500 to \$7000 per hectare.

Would you please consider the concept of this request and then contact me? Should your organisation wish to consider this matter I am able to provide a good deal of background information and plans. My telephone number is 570 6774.

Thanks for considering this request. I look forward to hearing from you.

52055

Yours sincerely

A handwritten signature in cursive script that reads "Kelly Crandle".

Kelly Crandle
RESERVES ASSET MANAGER

CS 2-15

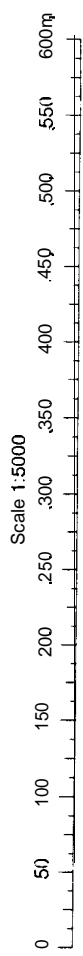
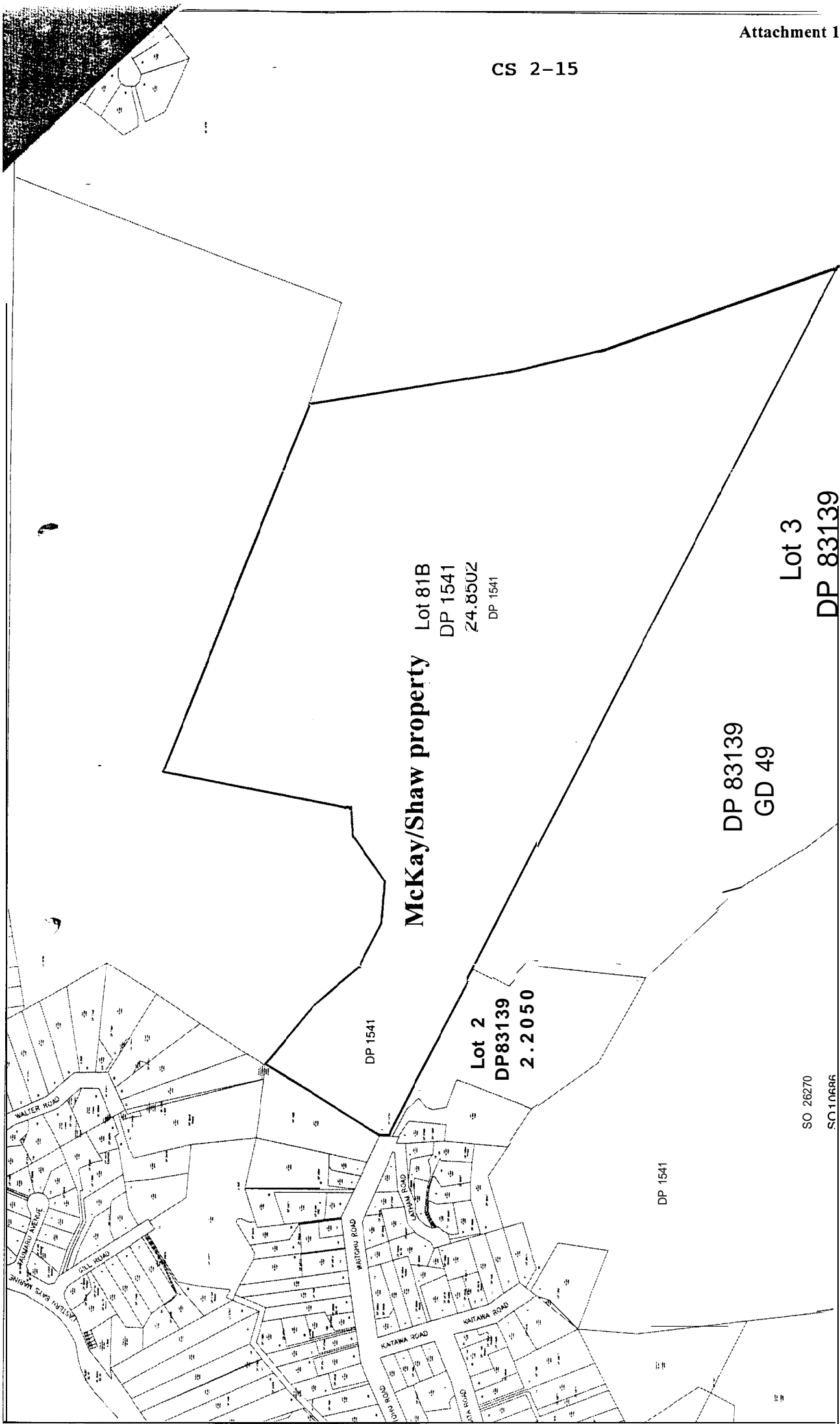

WAITOHU ROAD (LOWER HUTT CITY)
 TERRALINK NZ LTD (Terraviva)-DCDB Data as at 20.03.2000 Title & Valuation data as at 20.03.2000 Geodetic data as at 11.10.97
 Cadastral Information from LINZ Digital Cadastral Database (DCDB) CROWN COPYRIGHT RESEAVED.

APPENDIX 3: Plan showing layout of McKay/Shaw property, Lowry Bay